



【SPECIFICATION FOR APPROVAL】

SAN TUO P/N	NR6028 Series	DATE	2015/11/1	REV	A
--------------------	----------------------	-------------	------------------	------------	----------

变更履历

版本	变更项目	变更前内容	变更后内容	变更日期
A	初版	—	—	2015/11/1



【 SPECIFICATION FOR APPROVAL 】

SAN TUO P/N	NR6028 Series	DATE	2015/11/1	REV	A
-------------	---------------	------	-----------	-----	---

Wire Wound SMD Power Inductors–ANR Series

Operating temperature range: -40℃~+125℃ (Including self-heating)

1.PART NUMBERING SYSTEM

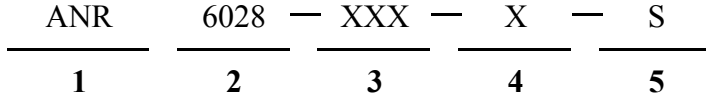

1.SERIES NAME

2.DIMENSIONS

3.TYPE

4.INDUCTANCE

5.TOLERANCE CODE: J:±5% K:±10% L:±15% M:±20% P:±25% N:±30%

6.INTERNAL IDENTIFICATION

2.FEATURES:

- Magnetic-resin shielded coANRuction reduces buzz noise to ultra-low levels
- Metallization on ferrite core results in excellent shock resistance and damage-free durability
- Closed magnetic circuit design reduces leakage flux and Electro Magnetic Interference (EMI)
- 30% higher current rating than conventional inductors of equal size
- Takes up less PCB real estate and save more power

3.APPLICATIONS

- LED Lighting
- Next-generation mobile devices with multifunction such as mobile TV and digital movie cameras
- Flat-screen TVs, blue-ray disc recorders, set top box
- Notebooks, desktop computers, servers, graphic cards cards
- Portable gaming devices, personal navigation systems, personal multimedia devices
- Automotive systems
- Telecomm base stations

【SPECIFICATION FOR APPROVAL】

SAN TUO P/N	NR6028 Series	DATE	2015/11/1	REV	A
-------------	---------------	------	-----------	-----	---

1. Appearance shape (unit : mm)

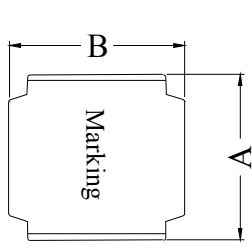

Top View

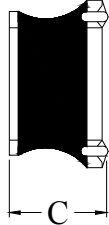

Front View

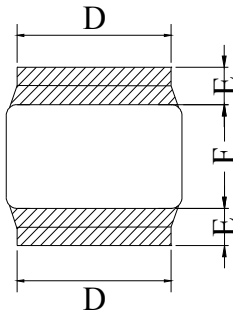

Bottom View

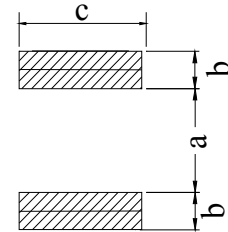

Recommended Land Pattern

2. Appearance size(unit : mm) Tolerance:

A	B	C	D	E	F	a	b	c		
6.0±0.3	6.0±0.3	2.8Max	4.9Typ.	1.7Typ.	2.6Typ.	2.8Typ.	1.7Typ.	5.7Typ.		

3. Test instruments

L: TH2826A LCR METER (or equivalent)

Isat: CH2815 LCR METER+VR7220 DC SUPPLIER (or equivalent)

DCR: HK502BC MILLIOHMMETER (or equivalent)



【SPECIFICATION FOR APPROVAL】

SAN TUO P/N	NR6028 Series	DATE	2015/11/1	REV	A
-------------	---------------	------	-----------	-----	---

4. CHARACTERISTICS

P/N	Inductance 电感 @100KHz,1V	DC Resistance 直流电阻 (±30%)	Saturation Current 饱和电流	Heat Rating Current 温升电流	Marking 印字
Units	uH	Ω	A	A	
Symbol	L	DCR	Isat	Irms	
ANR6028-1R0N	1.0±30%	0.012	6.70	4.60	1R0
ANR6028-1R5N	1.5±30%	0.016	6.00	4.30	1R5
ANR6028-2R2N	2.2±30%	0.020	5.10	3.75	2R2
ANR6028-3R3N	3.3±30%	0.025	3.63	3.40	3R3
ANR6028-4R7N	4.7±30%	0.033	3.00	3.00	4R7
ANR6028-5R6N	5.6±30%	0.045	2.80	2.45	5R6
ANR6028-6R8M	6.8±20%	0.056	2.60	2.40	6R8
ANR6028-8R2M	8.2±20%	0.068	2.40	2.25	8R2
ANR6028-100M	10±20%	0.078	2.05	1.90	100
ANR6028-120M	12±20%	0.088	1.80	1.70	120
ANR6028-150M	15±20%	0.125	1.75	1.50	150
ANR6028-180M	18±20%	0.130	1.55	1.45	180
ANR6028-220M	22±20%	0.140	1.45	1.40	220
ANR6028-270M	27±20%	0.180	1.40	1.30	270
ANR6028-330M	33±20%	0.220	1.35	1.10	330
ANR6028-390M	39±20%	0.225	1.25	1.10	390
ANR6028-470M	47±20%	0.280	1.15	1.05	470
ANR6028-680M	68±20%	0.420	0.95	0.85	680
ANR6028-820M	82±20%	0.550	0.80	0.70	820
ANR6028-101M	100±20%	0.670	0.65	0.60	101

※1: All test data is referenced to 20° C ambient;
 ※2: Rated current: Isat or Irms, whichever is smaller;
 ※*3: Isat: DC current at which the inductance drops approximate 30% from its value without current;
 ※*4: Irms: DC current that causes the temperature rise ($\Delta T = 40^{\circ} C$) from 20° C ambient.



【SPECIFICATION FOR APPROVAL】

SAN TUO P/N		DATE		REV	A
-------------	--	------	--	-----	---

1.DIMENSIONS FOR CARRIER TAPES:

ITEM	W	A0	B0	K0	K1	P	F	E	D0	D1	P0	P2	T
DIM	16.00	6.40	6.40	3.3	0.00	8.00	7.50	1.75	1.50	0.00	4.00	2.00	0.4
	+0.3	+0.1	+0.1	+0.1	+0.0	+0.1	+0.15	+0.1	+0.1	+0.0	+0.1	+0.1	+0.05
	-0.3	-0.1	-0.1	-0.1	-0.0	-0.1	-0.15	-0.1	-0.0	-0.0	-0.1	-0.1	-0.05

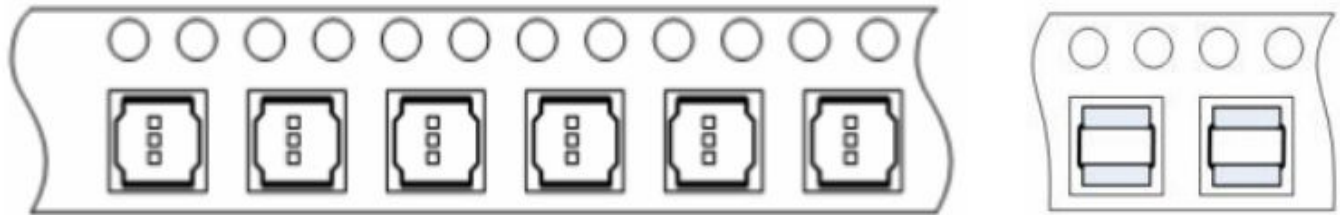
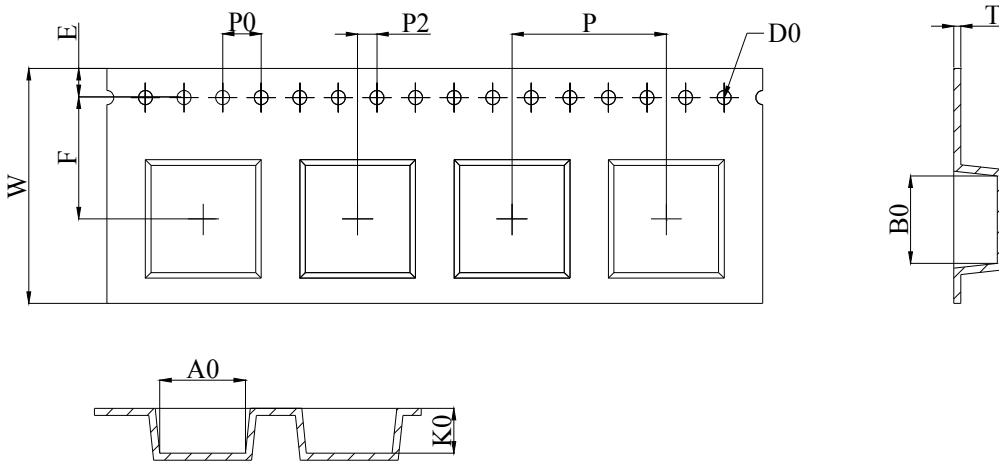

2.PACKING(mm)

载带宽度 (W)	间距 (P)	卷 (PCS) 13inch	3卷/2袋 (PCS)	2袋/内箱 (PCS)	5内箱/外箱 (PCS)
16mm	8mm	2000	6000	6000	30000

备注:

1. 包装袋规格: 375*400mm (REF.) .
2. 内箱规格: 340*70*340mm (REF.) .
3. 外箱规格: 375*360*360mm (REF.) .