

SPECIFICATION OF RC SERIES

APPLICATIONS

Enclosures for channel-type EMI suppressor snaps.

- * Internal and external power cables
- * Internal cables between PC boards and data connectors

ORDERING CODE

K5B RC 16 x 13 x 8 - M
 (1) (2) (3) (4) (5) (6)

- (1) MATERIAL
- (2) PRODUCT CODE
- (3) CORE OD
- (4) CORE LENGTH
- (5) CORE ID
- (6) PLASTIC CLAMPS



SHAPE

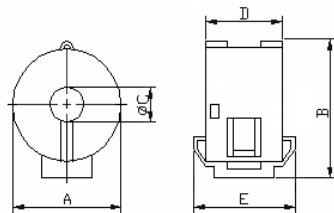

FIG 1

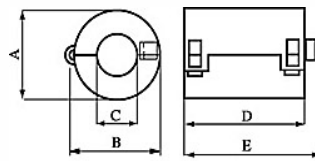

FIG 2

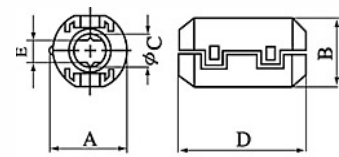

FIG 3

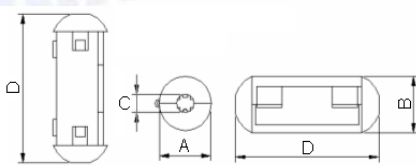

FIG 4

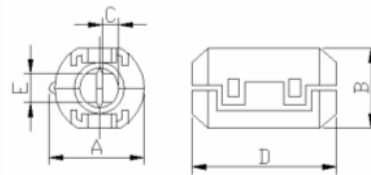

FIG 5

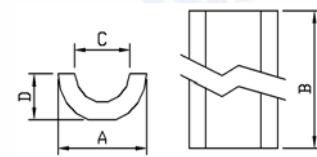

FIG 6

DIMENSIONS & CHARACTERISTICS

UNIT:mm

NO.	ORDERING CODE		A	B	C	D	E	Applicable cable(max)	Fig
1	RC 10x20x5	M	13.00±1.00	12.00±1.00	5.00±1.00	25.50±1.00	2.40±0.50	3.5	3
2	RC 12x15x7	M	14.00±1.00	15.50±1.00	7.00±1.00	18.00±1.00	22.00±1.00	7	2
3	RC 13x23x7	M	17.00±1.00	15.00±1.00	7.00±1.00	30.00±1.00	3.00±1.00	4	3
4	RC 14x28.5x7	M	20.00±1.00	20.00±1.00	8.50±1.00	39.00±1.00	-	7	4
5	RC 16x13x8	M	19.50±1.00	23.00±1.00	8.00±1.00	17.00±1.00	23.00±1.00	8	1
6	RC 16x16x8	M	19.20±1.00	23.40±1.00	8.20±1.00	20.00±1.00	26.10±1.00	8	1
7	RC 16x28x8	M1	19.50±1.00	20.00±1.00	9.50±1.00	31.00±1.00	35.00±1.00	8	2
8	RC 16x28x9	M1	19.50±1.00	20.00±1.00	9.50±1.00	31.00±1.00	35.00±1.00	9	2
9	RC 16x28x9	M2	20.00±1.00	18.00±1.00	9.50±1.00	36.00±1.00	6.50±1.00	9	3
10	RC 17.5x28.5x9.5		17.50±0.30	28.50±0.60	9.50±0.25	8.75(+0.00/-0.60)	-	9	6
11	RC 17x28x11	M	20.50±1.00	20.50±1.00	11.00±1.00	31.50±1.00	36.00±1.00	11	2
12	RC 20x30x5	M	23.00±1.00	22.00±1.00	5.00±1.00	36.00±1.00	10.00±1.00	4*1.5	5
13	RC 20x30x13	M	23.00±1.00	22.00±1.00	13.50±1.00	36.00±1.00	10.00±1.00	12	3
14	RC 20.5x10x10.2	M	24.50±1.00	28.50±1.00	10.20±1.00	13.50±1.00	20.00±1.00	10	1
15	RC 24x14x11.5	M	28.00±1.00	31.50±1.00	11.50±1.00	18.00±1.00	24.00±1.00	11.5	1
16	RC 25x12x15	M	29.00±1.00	33.00±1.00	15.00±1.00	15.50±1.00	21.50±1.00	15	1
17	RC 26x30x13	M	30.75±1.00	31.00±1.00	13.00±1.00	34.00±1.00	39.00±1.00	13	2
18	RC 35.5x15x23		35.50±0.60	15.00±0.40	22.50-23.00	17.40±0.20	-	22	6

※Other sizes are available upon request.

※All the data listed in this catalogue are for reference only, King Core reserves the right to alter or revise the specifications without prior notification.

SPECIFICATION OF RC SERIES

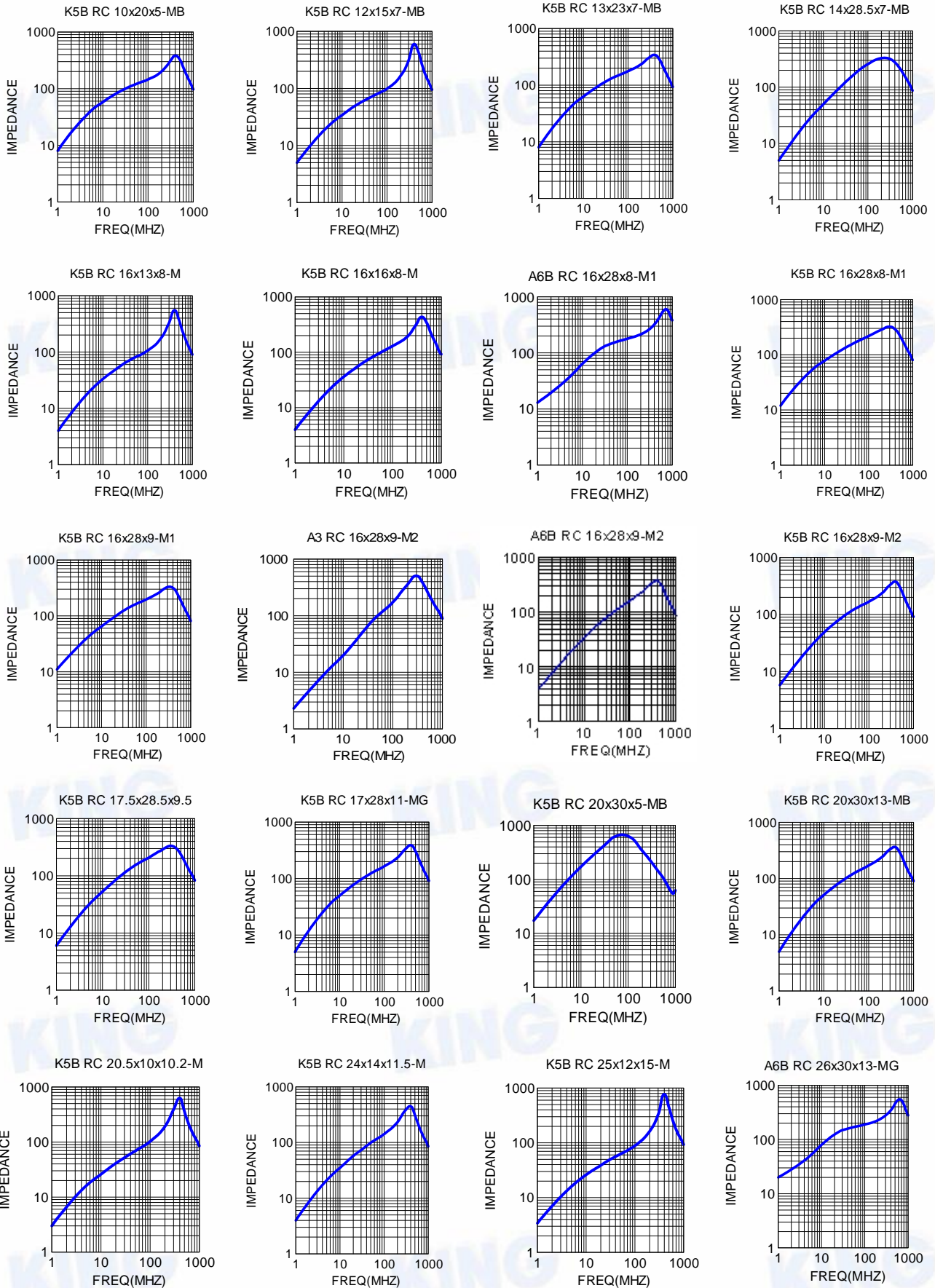

※Other sizes are available upon request.

※All the data listed in this catalogue are for reference only, King Core reserves the right to alter or revise the specifications without prior notification.

SPECIFICATION OF RC SERIES

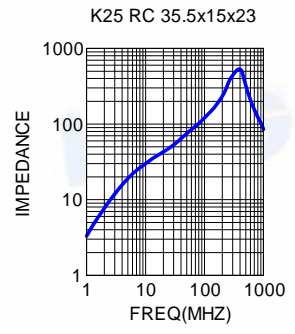
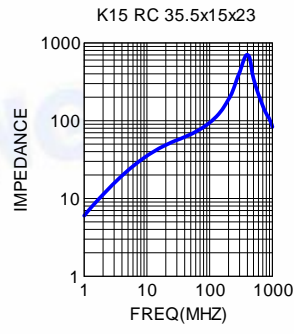
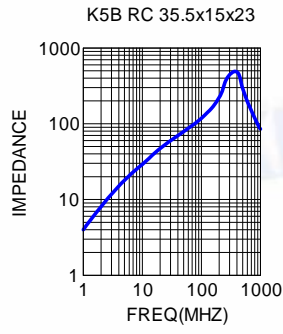
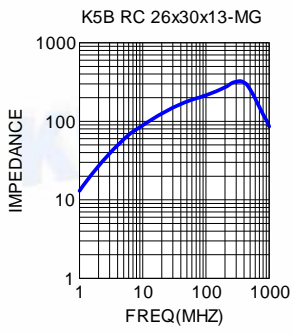

※Other sizes are available upon request.

※All the data listed in this catalogue are for reference only, King Core reserves the right to alter or revise the specifications without prior notification.